

TECHNICAL SPECIFICATIONS

AMATURO THEATER



BROWARD CENTER
FOR THE PERFORMING ARTS

Fort Lauderdale, Florida
October 2015

TABLE OF CONTENTS

| | |
|---|----|
| GENERAL CONTACT INFORMATION..... | 2 |
| MAP & DIRECTIONS..... | 3 |
| TRUCK, BUS & VEHICLE PARKING..... | 3 |
| SITE PLAN..... | 4 |
| LOADING DOCK INFO..... | 6 |
| SEATING CAPACITY..... | 7 |
| SEATING CHART..... | 8 |
| STAGE SPECIFICATIONS..... | 9 |
| ORCHESTRA PIT / STAGE THRUST INFORMATION..... | 9 |
| STAGE DIMENSIONS & GROUND PLAN..... | 10 |
| RIGGING SPECIFICATIONS / OBSTACLES..... | 12 |
| SOFTGOODS INVENTORY..... | 12 |
| HANGING PLOT / LINE SCHEDULE..... | 13 |
| SOUND AND COMMUNICATIONS..... | 15 |
| LIGHTING INFORMATION..... | 19 |
| POWER DISTRIBUTION..... | 19 |
| GENIE LIFT..... | 19 |
| DIMENSIONAL INFORMATION..... | 20 |
| ORCHESTRA EQUIPMENT / CONCERT SHELL INFORMATION..... | 32 |
| DRESSING ROOMS/SUPPORT SPACES..... | 33 |
| BACKSTAGE MAP..... | 36 |
| LOCAL SERVICES (Ground Transportation & Lodging)..... | 37 |
| MEDICAL: HOSPITAL AND DOCTORS..... | 43 |

Amaturo Theatre

at the

Broward Center for the Performing Arts

201 Southwest 5th Avenue
Fort Lauderdale, FL 33312
Main Office (954) 522-5334 (M-F 8:30A-5:30P)
Main Fax (954) 468-2549
Box Office (954) 468-3338

PRODUCTION STAFF

| | | | |
|--------------------------|-----------------|----------------|--|
| Director of Production | Tim Lessig | (954) 468-2557 | tlessig@browardcenter.org |
| Production Supervisor | Chris Jahn | (954) 765-5802 | cjahn@browardcenter.org |
| Production Supervisor | Lucas Bonewits | (954) 468-3317 | lbnewits@browardcenter.org |
| Production Coordinator | Diane DeChello | (954) 765-5819 | ddechello@browardcenter.org |
| Production Assistant | Rebecca Feldman | | rfeldman@browardcenter.org |
| Production Assistant | Scott Genn | (954) 468-3319 | sgenn@browardcenter.org |
| Production Assistant | Britni Serrano | | bserrano@browardcenter.org |
| Production Fax | | (954) 468-3315 | |
| Stage Door Security Desk | | (954) 468-3323 | |

EVENT SERVICES STAFF

| | | | |
|------------------------------|-----------------|----------------|--|
| Vice President of Operations | Shelly Bradshaw | (954) 468-2696 | sbradshaw@browardcenter.org |
| Event Manager | Pablo Urquilla | (954) 468-3313 | purquilla@browardcenter.org |
| Associate Event Manager | Kerry McCloskey | (954) 414-6905 | kmccloskey@browardcenter.org |

STAGE LABOR - I.A.T.S.E. Local 500

The Broward Center for the Performing Arts employs members of I.A.T.S.E. Local 500 for all productions in the Au-Rene Theatre. For further information, please contact Production Staff for labors rates and work rules.

| | | | |
|---------------------------|-------------------|-------------------------|--|
| Head Carpenter | Sam Goldstein | (954) 522-5334 ext 4018 | chimchim0445@yahoo.com |
| Head Sound | Rich Szczublewski | (419) 973-1267 | rsblski@gmail.com |
| Head Electrician | Chris Tamber | (954) 522-5334 ext 4016 | ctamber67@gmail.com |
| Assistant Sound | Parrish Thompson | | |
| Business Agent Local #500 | Terry McKenzie | (954) 881-2353 | termack500@gmail.com |

ADDITIONAL CONTACTS INFORMATION

| | | | |
|------------------------------|----------------|----------------|--|
| Director of Guest Services | David Dillon | (954) 468-3305 | ddillon@browardcenter.org |
| Director of Food & Beverages | Vinnie Venezia | (954) 468-3337 | vvenezia@browardcenter.org |

MAP & DIRECTIONS

The Broward Center is conveniently located in the Riverwalk Arts & Entertainment District in downtown Fort Lauderdale, equidistant between Dade and Palm Beach Counties and can be reached by several routes.

From Interstate-95:

Exit at Broward Boulevard, Go east.

From Florida Turnpike (southbound):

Exit at Sunrise Boulevard, Go East to South-bound I-95, exit Broward Boulevard, Go east.

From Florida Turnpike (northbound):

Exit at I-595, Go East to North-bound I-95, exit Broward Boulevard, Go east.

To Backstage Parking Lot:

From Broward Boulevard turn right (South) onto SW 7th Avenue (Avenue of the Arts). Turn left at West Las Olas Blvd (the second light). Take an immediate left into the backstage lot security gate. Push the buzzer to contact guard. Identify yourself and guard will let you enter.

To Parking Garage and Valet:

Broward Boulevard. Turn South onto SW 5th Avenue. The Arts and Science Parking Garage is on the immediate right, or, proceed straight ahead, cross 2nd Street (Himmarshee St.) and continue to the top of the hill for valet service.

From Fort Lauderdale Airport to Backstage Lot:

Take the "US1 / Federal Highway Northbound" exit out of the Airport. Travel North on US1 to SE 17th Street Causeway. Turn left (West) and go to SW 4th Avenue and turn right (North). SW 4th Avenue will become SW 7th Avenue at the bridge. Go over the bridge, turn right at West Las Olas Blvd . Take an immediate left into the backstage lot security gate. Push the buzzer to contact guard. Identify yourself and guard will let you enter.

North Gate - Trucks going to Loading Dock:

From Broward Boulevard turn South onto SW 5th Avenue. Turn right at Second Street (Himmarshee Street). The gate entrance to back-stage lot is on your left. Push the buzzer to contact guard. Identify yourself and guard will let you enter.

GPS Address (do not use for anything else!)

To the backstage Security gate:
641 West Las Olas Boulevard
Fort Lauderdale

To the North Gate (truck & bus parking)
582 SW 2nd Street
Fort Lauderdale FL

TRUCK, BUS & VEHICLE PARKING

Truck & Bus Parking on site is limited. There is parking available directly backstage in the lot for 10 cars and additional parking available for 40 cars in the Arts and Science parking garage located across the street from the theatre. All parking arrangements must be discussed with Production Staff prior to the event for necessary passes and badges.



Broward Center Site Plan

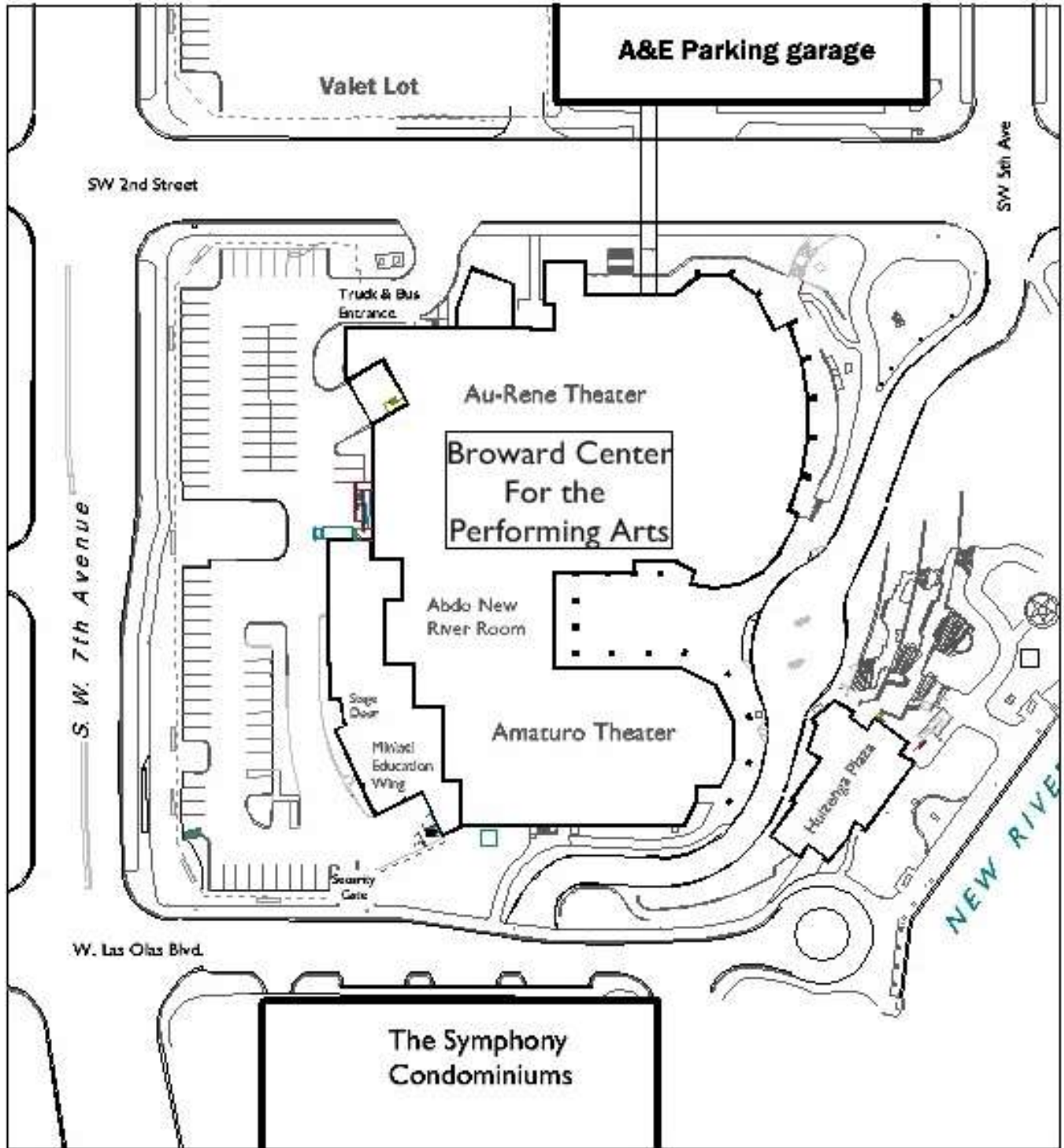

BCPA Parking Lot



LOADING DOCK

The Amataro Loading Dock is located at the southwest corner of the building at S.W. 7th Ave and Las Olas Boulevard, but trucks must use the entrance on the north end of the parking lot on Himmarshee Street. There are two loading bays. The dock is 3' high, and the receiving doors are 8' wide by 8' high. The doors from the receiving area onto the stage are 7'-6" w x 25' h'.

The receiving area is used to store the Amataro's orchestra shell, as well as other equipment, depending on activities within the building. This will not impede loading equipment into the theater, but if you need that space during your event, please discuss with the Production Department in advance of your event.

Prior notice is necessary if the dock will be accommodating a tractor trailer longer than 40'; part of the lot must be reserved so the truck can maneuver. Shore Power is available, but you must supply your own tails.

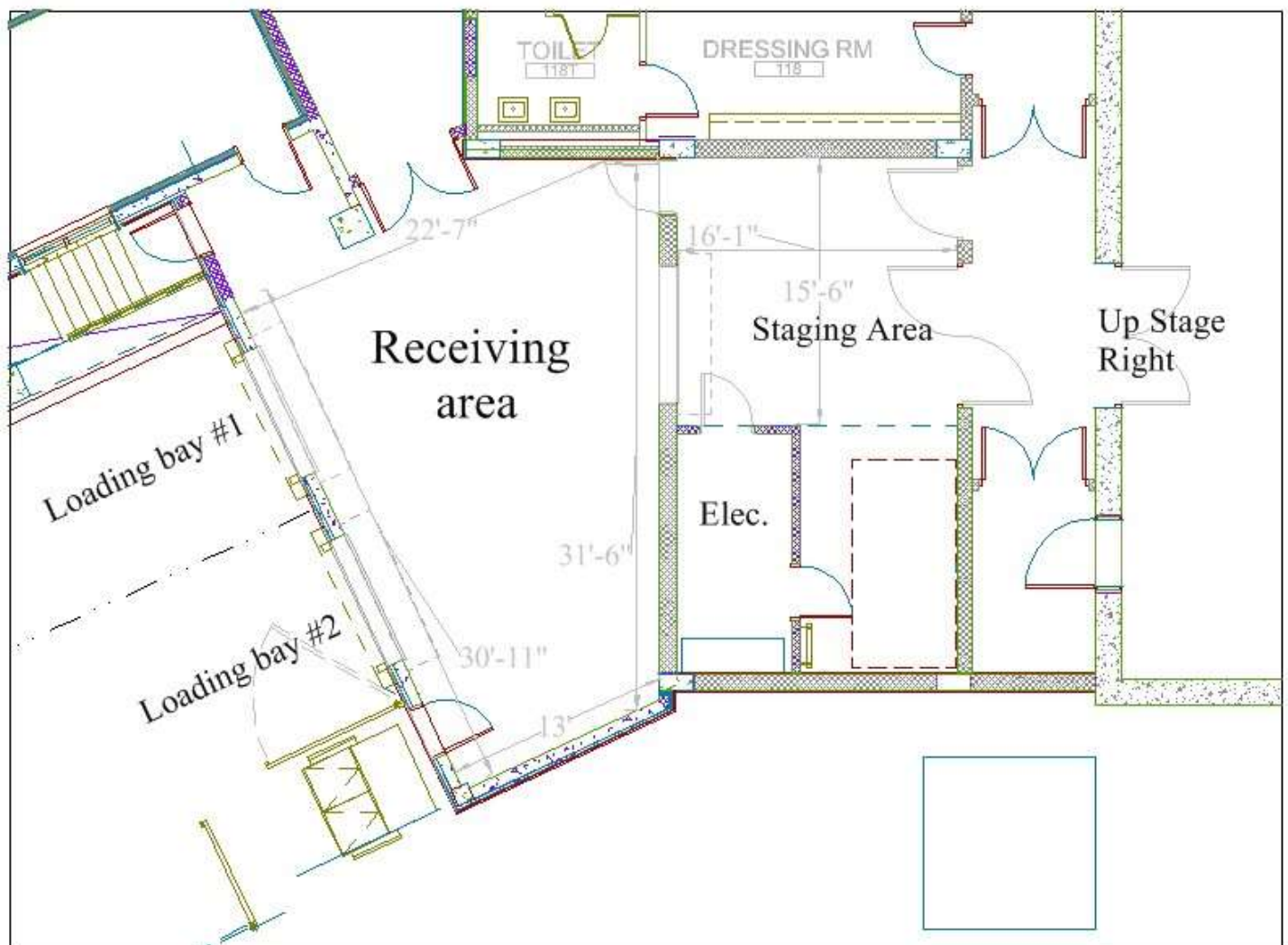

SEATING INFORMATION AND CAPACITY

(MAXIMUM SEATING CAPACITY IS 582 SEATS (See seating map on follow page)

| | | |
|-------------------|------------|-----------------|
| Orchestra Section | Rows A – T | 488 seats |
| Side Tiers | Rows V – W | 86 Seats |
| Box Seats | | 8 Seats |
| | | Total 582 seats |



SEATING CHART

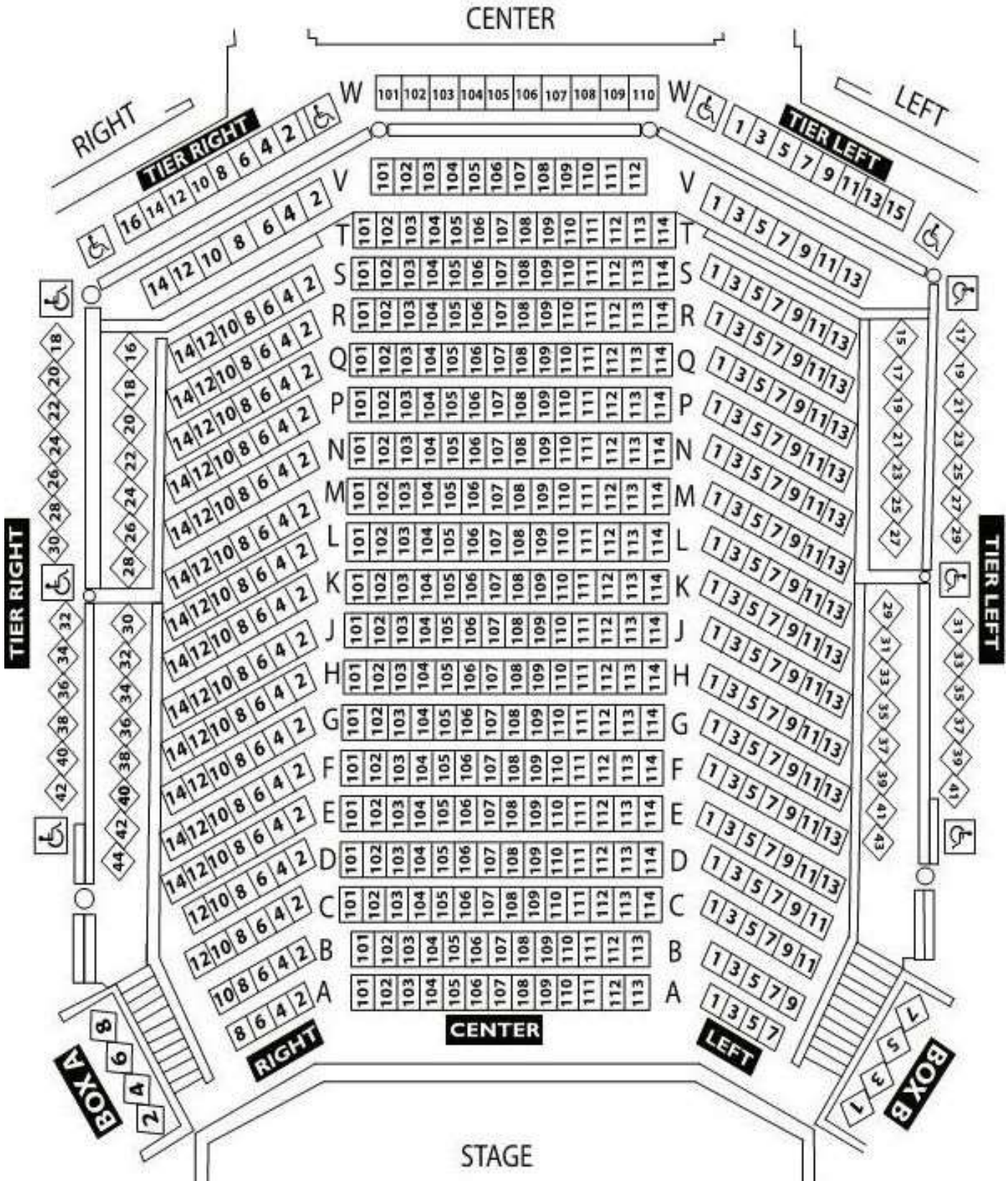

STAGE SPECIFICATIONS

STAGE FLOOR is a semi-sprung floor with double layer tongue and groove plywood on aluminum sleepers over rubber blocks, and finished with black masonite/bennelex. The rubber blocks are surrounded by a steel channel which limits over-decompression. Any damage to floor incurred by a production must be restored.

| | |
|--|---------|
| HEIGHT OF GRID | 50' |
| HEIGHT OF PROSCENIUM | 25' |
| WIDTH OF PROSCENIUM | 39' 10" |
| HEIGHT OF GALLERIES | |
| Upper Loading Gallery | 50' |
| Middle Loading Gallery | 26' 6" |
| Pin Rail SL | 25' 5" |
| DEPTH OF STAGE (from Plaster Line) | 40' |
| WIDTH OF STAGE | 75'-6" |
| Width of stage (center to SR) | 32' |
| Width of stage (center to SL) | 39' -6" |
| CENTER STAGE TO PINRAIL SR | 36' |
| APRON (from Plaster Line) | 1' -7" |
| (from House Curtain) | 2' -7" |
| FULL THRUST (from Plaster line) | 10' -7" |
| (from House Curtain) | 11' -7" |
| HEIGHT OF STAGE (seating level to stage level) | 3' -4" |

ORCHESTRA PIT

The Pit has a cover that extends the stage apron to 10' -7". This cover consists of 15 pieces that are manually moved down to create the floor of the Pit for use. The Pit under-hang is 5' -6"

| | |
|---|-------------------------|
| Opening (Stage Edge to DS Pit Wall) | 9' |
| Overall Dimensions (including pit under-hang) | 40' x 14' 6" (D shaped) |
| Approximate Capacity of Musicians | 35 |
| HEIGHT OF PIT (pit level to stage level) | 8' -3" |

STAGE DIMENSIONS & GROUND PLAN

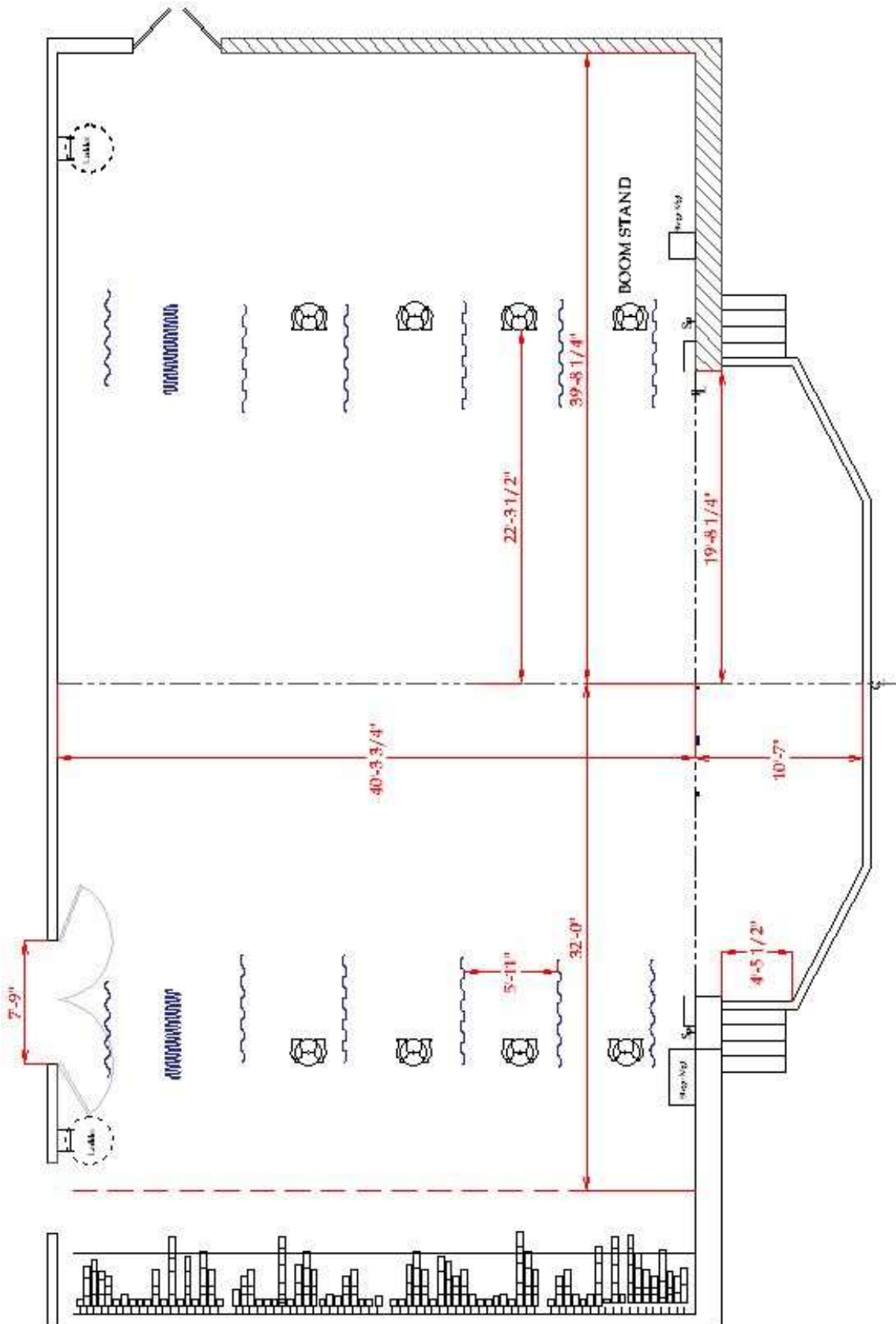

Amaturo Section View

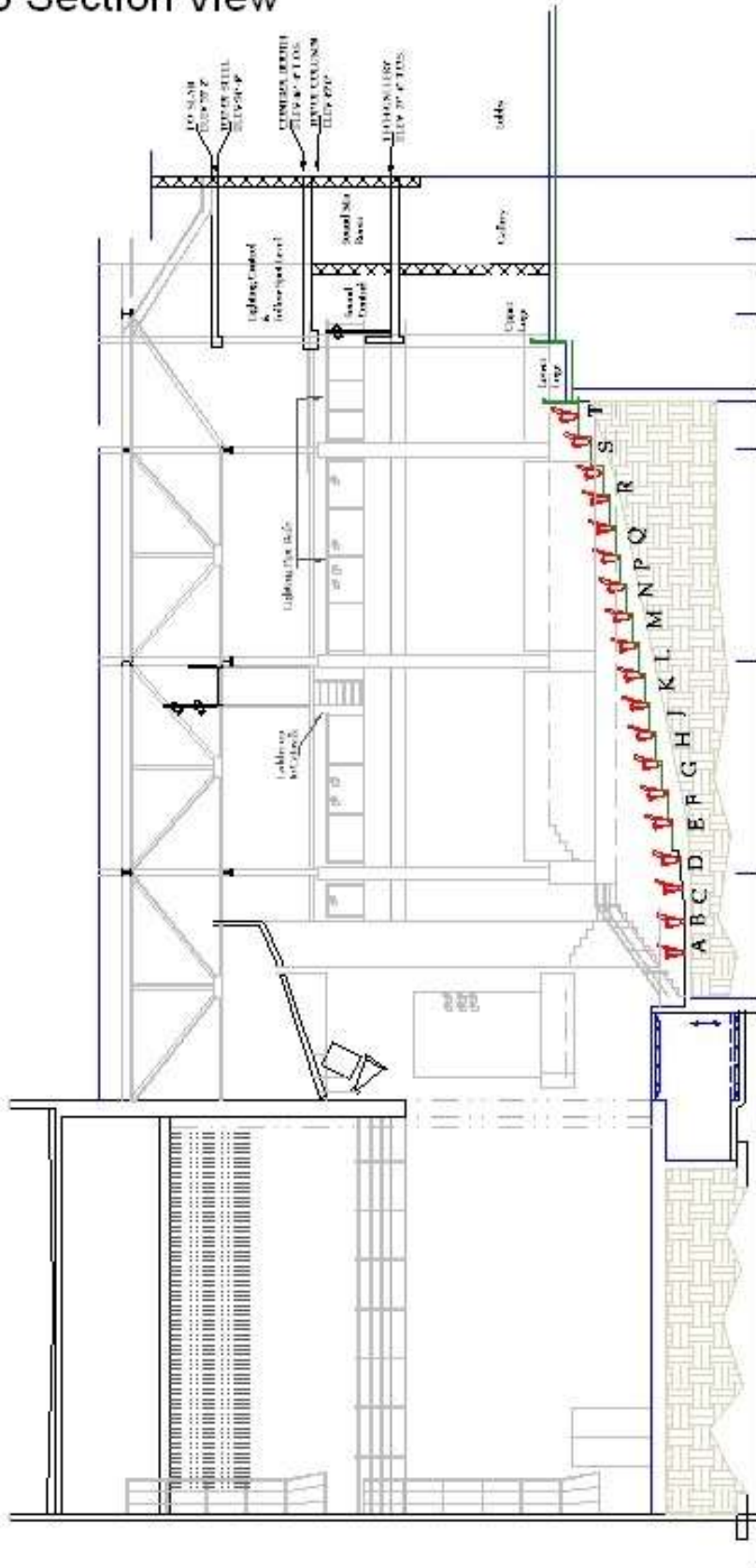

RIGGING SPECIFICATIONS

Single purchase counterweight, hand-operated line sets operated from the deck stage right.

| | |
|------------------------|----------------------------|
| NUMBER OF LINE SETS | 73 line sets, 6" on center |
| GRID HEIGHT | 50' |
| TRAVEL DISTANCE | 48' |
| MAX WEIGHT PER ARBOR | 1400 lbs |
| TOTAL WEIGHT AVAILABLE | 102,200 lbs |
| LENGTH OF BATTENS | 48' |
| TAB PIPES (5 pairs) | 26' OC SL & SR |

HOUSE CURTAIN is a manual counterweight guillotine center split velour curtain located 5" upstage from smoke pocket. Curtain is operated from stage level down stage right and is not part of the operating rail. House Curtain is permanent and cannot be moved or removed.

SOFT GOODS INVENTORY

- 6 black velour borders (10' h x 48' w)
- 12 black velour legs (27' h x 10' w)
- 8 Black Velour tabs (27' h x 4' w)
- 1 black velour split traveler curtain (27' h x 45' w)
- 2 black velour curtains (27' h x 45' w)
- 1 black sharks tooth scrim (27' h x 48' w)
- 1 white cyclorama (27' h x 48' w)

Hanging Plot

| SHOW: | | | | |
|-------------------|-----------------|----------------------------|------------------|---------------|
| Line Set # | Position | House Hang | Show Hang | Weight |
| | 0" | Smoke Pocket | | |
| | 5" | House curtain | | |
| 1 | 1'8" | #1 black border | | |
| 2 | 2'2" | Flying Microphones | | |
| 3 | 2'8" | #1 Black Legs | | |
| 4 | 3'2" | Electric #1 | | |
| 5 | 3'8" | | | |
| 6 | 4'2" | | | |
| 7 | 4'8" | Electric #1A LED PARs | | |
| 8 | 5'2" | | | |
| 9 | 5'8" | | | |
| 10 | 6'2" | Electric #1B Moving Lights | | |
| 11 | 6'8" | | | |
| 12 | 7'2" | | | |
| 13 | 7'8" | | | |
| 14 | 8'2" | #2 black border | | |
| 15 | 8'8" | #2 black legs 19' | | |
| 16 | 9'2" | | | |
| 17 | 10'2" | Electric #2 | | |
| 18 | 10'8" | | | |
| 19 | 11'2" | | | |
| 20 | 11'8" | Electric #2A LED Zoom | | |
| 21 | 12'2" | | | |
| 22 | 12'8" | | | |
| 23 | 13'2" | | | |
| 24 | 13'8" | | | |
| 25 | 14'2" | #3 black border | | |
| 26 | 14'8" | #3 black legs 19' | | |
| 27 | 15'2" | | | |
| 28 | 15'8" | Black Scrim | | |
| 29 | 16'2" | Blackout Drop | | |
| 30 | 16'8" | | | |
| 31 | 17'2" | Electric #3 | | |
| 32 | 17'8" | | | |
| 33 | 18'2" | | | |
| 34 | 18'8" | Electric #3A LED PARs | | |
| 35 | 19'2" | | | |
| 36 | 20'1" | Electric #3B Moving Lights | | |
| 37 | 20'8" | | | |

| | | | | |
|----|--------|-------------------------------|--|--|
| 38 | 21'2" | | | |
| 39 | 21'8" | #4 black border | | |
| 40 | 22'2" | #4 black legs 19' | | |
| 41 | 22'8" | | | |
| 42 | 23'2" | | | |
| 43 | 23'8" | | | |
| 44 | 24'2" | Electric #4 | | |
| 45 | 24'8" | | | |
| 46 | 25'2" | | | |
| 47 | 25'8" | Electric #4A LED PARs | | |
| 48 | 26'2" | | | |
| 49 | 26'8" | | | |
| 50 | 27'2" | | | |
| 51 | 27'8" | | | |
| 52 | 28'2" | #5 black border | | |
| 53 | 28'7" | #5 black legs 19' | | |
| 54 | 29'1" | | | |
| 55 | 30'2" | | | |
| 56 | 30'8" | Electric #5 | | |
| 57 | 31'2" | | | |
| 58 | 31'8" | | | |
| 59 | 32'2" | #6 black border | | |
| 60 | 32'8" | | | |
| 61 | 33'2" | Black Traveler Curtain | | |
| 62 | 33'8" | | | |
| 63 | 34'2" | #6 Electric (5 Far Cyc 3 Cir) | | |
| 64 | 34'8" | | | |
| 65 | 35'2" | | | |
| 66 | 35'8" | | | |
| 67 | 36'2" | | | |
| 68 | 36'8" | | | |
| 69 | 37'2" | #6 black legs | | |
| 70 | 37'7" | White filled scrim-CYC | | |
| 71 | 38'1" | Blackout drop | | |
| 72 | 38'6" | | | |
| 73 | 38'11" | | | |

SOUND AND COMMUNICATIONS

SPEAKER CONFIGURATION

The Amaturio Theater has a stereo line array system, flown flanking the proscenium opening to cover the entire auditorium, with a flown sub array in the center.

Main Arrays

The primary speaker system consists of two (2) Meyers line arrays consisting of eight MINA compact curvilinear array speakers.

Sub Array

The sub-woofer array consists of three Meyers 500-HP compact high-power subwoofers.

Front Fills

The front fills consist of 98 JBL 8110h speakers built into the lip of the stage.



Effects Speakers

8- EAW LC12 (mounted on side and rear walls of the theater)(wired for Surround Sound)

SOUND MIX POSITIONS

There is only one mixing position available in the Amaturro Theatre; it is located along the center of the rear wall, in the Tech Gallery. It is fully open to the room. (See photo on page 23)

FRONT OF HOUSE CONSOLE

Midas Pro 3 IP Digital Console Control Centre with 56 Input Channels, 27 Mix Buses and 96 kHz Sample Rate

SOURCE GEAR

2 – Sony Mini Disc machines with Auto Pause

1 – TASCAM CD-RW901MK2 CD player/recorder

MONITORS & MICROPHONES

NOTE: The following Monitor Equipment and Microphone package is shared with other venues at the Broward Center and may not be available for your event *unless prior arrangements have been made* with Production Staff in advance of your event.

MONITOR CONSOLE:

Yamaha PM5D-RH

MONITOR SPEAKERS:

- 2 Shure in-ear monitors PSM700 w/ E3 SHU P7TRE3
- 14 powered speakers Meyers UMP-100p
- 2 Stage monitors Meyers USM-100P
- 4 Side Fill speakers Meyers UPQ-1P
- 4 powered subwoofer – dual 10” Meyers UMS-1P
- 2 EV 1502 ER
- 6 JBL MRX 512M
- 5 EAW VM12
- 4 Galaxy hot spots
- 7 Anchor AN 1001 X
- 1 Anchor AN 1000 self-powered
- 1 Galaxy Audio Hot Spot PAIII self-powered hot spot

Portable Microphone Splitter:

- 1 58 pair Whirlwind splitter with 1 direct out and 2 ISO splits
- 1 15 Pair Wireworks splitter
- 6 15 Pair permanent Mic input mults home run to sound booth from various locations

MICROPHONES

WIRED MICROPHONES:

| <u>Manufacturer/Model</u> | <u>Quantity</u> | <u>Manufacturer/Model</u> | <u>Quantity</u> |
|---------------------------|-----------------|---------------------------|-----------------|
| Shure KSM 9 | 8 | Sennheiser ME 66 | 4 |
| Shure KSM 141 | 6 | Sennheiser MD421U | 3 |
| Shure KSM 32 | 6 | | |
| Shure Beta SM57 | 9 | Earthworks PM 40 | 2 |
| Shure Beta SM58 | 7 | Electro Voice RE320 | 2 |
| Shure SM81 | 5 | Electro Voice RV18 | 3 |
| Shure SM87A | 6 | Electro Voice RE20 | 4 |
| Shure Beta 98A | 8 | Electro Voice DS35 | 4 |
| Shure Beta 91 | 2 | Whirlwind PB 12 | 2 |
| Shure Beta 52 | 2 | Beyer M160 | 4 |
| Shure Beta 181S | 4 | | |
| Shure Beta 56 | 6 | Audio Tech AT857QMa | 3 |
| Shure Beta 57A | 8 | Audio Tech AT857QMLa | 1 |
| Shure WA310 | 12 | Crown PCC 160 | 8 |
| AKG C141 XLII/ST | 2 | Crown PZM LP6 | 3 |
| AKG C214 | 2 | Crown PZM 6RB | 4 |
| AKG C535 | 2 | Crown GLM 200 | 2 |
| Countryman ISOMAX 2 | 12 | B & K 401 I | 2 |
| Countryman ISOMAX 2H | 12 | | |
| Countryman M4HP5RF24EB | 6 | | |

WIRELESS MICROPHONES:

There are six (6) channels of Shure UR4D Diversity Receivers

- 6 Sure Beta 58 handheld transmitters
- 8 KSM9 alternate cartridge for handheld transmitters
- 6 UR1 Bodypack transmitters
- 3 Shure MKE 2 gold lavalier microphones
- 3 Countryman E6 earset microphones

There are 4 channels of SHURE U4D Receivers, Series J5, frequency agile 578-638 MHz

The following microphones are available for these receivers:

- 4 Shure U2 BETA 87A handheld transmitters
- 4 Shure U1 bodypack transmitters w/Countryman B-3 mics

There are 8 channels of SHURE SLX Receivers, Series H5, frequency agile 518-548 MHz

The following microphones are available for these receivers:

- 2 Shure BETA SM87 handheld transmitters
- 8 Shure SLX bodypack transmitters w/Countryman B-3 mics

There are 8 channels of Shure SLX receivers, Series L4, frequency agile 638-662 MHz

The following microphones are available for these receivers:

- 2 Shure BETA SM87
- 9 Shure SLX Lavaliers w/Countryman B-3 mics

DIRECT INPUT BOXES:

- | | | |
|----|------------------------------|------------|
| 10 | Countryman FET 85 | Passive DI |
| 6 | Radial Engineering JDI MKIII | Passive DI |
| 4 | Radial Engineering JPC | PC DI |
| 2 | Whirlwind PCDI | PC DI |

BACKSTAGE COMMUNICATIONS

The Amataro Theatre is equipped with a Clear Com 2 channel intercom system; stations are located in the control booths, spot booths, and in the wings (including the fly rail).

- 1 MS-702 2-Channel Headset/Speaker Main Station
- 7 RS-701 wired belt pack (single channel)
- 1 RS702 wired belt pack (double channel)
- 1 WBS670 Wireless Intercom Base Station
- 6 WTR-670 Wireless belt pack (single channel)

LIGHTING INFORMATION

The Amaturio Theater is equipped with an extensive permanent "house" lighting plot. It comes focused and colored as per that plot. Any refocusing of equipment during the load-in must be restored during the load-out. To obtain copies of lighting plot contact the production offices. Available in PDF, DWG, or hard copy.

CONTROL

- 1 ETC Gio with two fader panels, two LCD monitors
ETC Sensor3 dimmer racks

POWER DISTRIBUTION

- 2 100 amp 3 phase (1) DSR and (1) DSL
- 1 400 amp 3 phase USR at loading dock w/truck wall ports

FOLLOWSPOTS

- 2 Lycian HTI-400 Followspots located in tech gallery

COMPLETE INVENTORY

The Amaturio Theater has a permanent repertory light plot; therefore most of the inventory is hanging

| Unit Description | Detail | Total | Hanging | On Rack |
|-------------------------------|---------------------|-------|---------|---------|
| Colortran Ellipsoidal 5 deg. | #650-082 | 14 | 12 | 2 |
| Colortran Ellipsoidal 10 deg. | #650-072 | 49 | 44 | 5 |
| Colortran Ellipsoidal 15 deg | #650-052 | 4 | 4 | 0 |
| Colortran Ellipsoidal 20 deg | #650-042 | 95 | 90 | 5 |
| Colortran Ellipsoidal 30 deg | #650-032 | 111 | 106 | 5 |
| Colortran Ellipsoidal 40 deg | #650-022 | 82 | 80 | 2 |
| Colortran Ellipsoidal 50 deg | #650-012 | 6 | | 6 |
| PAR cans (P64) | Par 64 | 31 | 12 | 19 |
| Colorado LED Wash | Quad 2 Zoom Tour | 25 | 25 | 0 |
| Elation Moving Light | Satura Spot CMY Pro | 5 | 5 | 0 |
| Par 56 striplights | | 17 | 3 | 14 |
| Far Cyc | | 5 | 5 | 0 |
| | | | | |
| | | | | |
| | | | | |
| | | | | |
| 18' booms w/bases | | 2 | | |
| 36' Genie personnel lift | | 1 | | |

ONSTAGE SIDE LIGHT LADDERS: Dead-hung 26'-6" from CL, with a clearance of 10'.
SL/SR Ladders (4 adjustable ladders per side, instruments distributed equally to each)

- 32 ETC Source Four 26 deg 750W HPL (hung/circuited 2-1)
- 32 ETC Source Four 36 deg 750W HPL (hung/circuited 2-1)

DIMENSIONAL INFORMATION

| | |
|-----------------------------------|-----|
| Curtain line to Technical Gallery | 86' |
| Curtain line to FOH rail | 58' |
| Curtain line to Follow Spot booth | 90 |
| Technical Gallery R to L | 70' |



LIGHTING MAGIC SHEET

| | | | |
|--|---|--|---|
| <u>PINK FOH (fronts)</u> 7 6 5 4 3 2 1 | <u>BLUE FOH (fronts)</u> 17 16 15 14 13 12 11 | <u>AMBER FOH (fronts)</u> 26 25 23 22 21 | <u>N/C FOH (fronts)</u> (forest break-ups) 33 32 31 |
|--|---|--|---|

| | | | |
|--|--|---|--|
| <u>BOX BOOM PINK</u> (mainly for apron) 9 8 303 301 | <u>BOX BOOM BLUE</u> (mainly for apron) 19 18 313 311 | <u>FRONT RED WASH</u> 36 <u>FRONT DARK BLUE</u> WASH 35 | <u>PINK DOWN</u> 75 74 73 72 71 |
|--|--|---|--|

| | | | |
|--|---|---|--|
| <u>BLUE STRIPS</u> 47 48 47 45 46 45 43 44 43 41 42 41 | <u>RED STRIPS</u> 57 58 57 55 56 55 53 54 53 51 52 51 | <u>AMBER STRIPS</u> 67 68 67 65 66 65 63 64 63 61 62 61 | <u>BLUE DOWN</u> 80 79 78 77 76 |
|--|---|---|--|

| | | | |
|---|--|--|--|
| <u>PINK HI SIDES</u> 90 85 89 84 88 83 87 82 86 81 | <u>BLUE HI SIDES</u> 100 95 99 94 98 93 97 92 96 91 | <u>BLUE BACK LT.</u> 139 138 137 136 135 118 135 134 133 113 132 131 108 130 | <u>SHINS (Booms)</u> 218 214 217 213 216 212 215 211 |
|---|--|--|--|

| | | | |
|--|--|---|--|
| <u>BOOM PINK</u> 178 174 177 173 176 172 175 171 | <u>BOOM N/C LEAVES</u> 188 184 187 183 186 182 185 181 | <u>BOOM AMBER</u> 198 194 197 193 196 192 195 191 | <u>BOOM LAVENDER</u> 208 204 207 203 206 202 205 201 |
|--|--|---|--|

| | | | |
|-----------------------------|--|--|-------------------------------|
| <u>APRON RED</u> 312 312 | <u>SOLO SPOT SPECIALS</u> 297 298 299 | | <u>MIRROR BALL</u> 220 219 |
|-----------------------------|--|--|-------------------------------|

| | | | |
|----------------------------------|--|--|---------------------------------------|
| <u>APRON LAVENDER</u> 302 302 | <u>APRON PINK</u> 308, 306 307, 305 | <u>APRON BLUE</u> 318, 317 316, 315 | <u>APRON N/C</u> 324, 323 322, 321 |
|----------------------------------|--|--|---------------------------------------|

| | | | |
|--------------------------------|-------------------------------|---------------------------------|--------------|
| <u>BLUE CYC</u> 282 281 280 | <u>RED CYC</u> 285 284 283 | <u>AMBER CYC</u> 288 287 286 | <u>NOTES</u> |
|--------------------------------|-------------------------------|---------------------------------|--------------|

FOCUSABLE UNITS:

| | | |
|----------------------|---|--|
| <u>1ST ELECTRIC:</u> | 101, 102, 103, 104, 105, 151, 152, 153, 154, 167 | |
| <u>2ND ELECTRIC:</u> | 106, 107, 109, 110, 155, 156, 157, 158 | |
| <u>3RD ELECTRIC:</u> | 111, 112, 114, 115, 159, 160, 161, 162 | |
| <u>4TH ELECTRIC:</u> | 116, 117, 119, 120, 163, 164, 165, 166 | |
| <u>5TH ELECTRIC:</u> | 121, 122, 123 | |

Lighting Plot: FOH

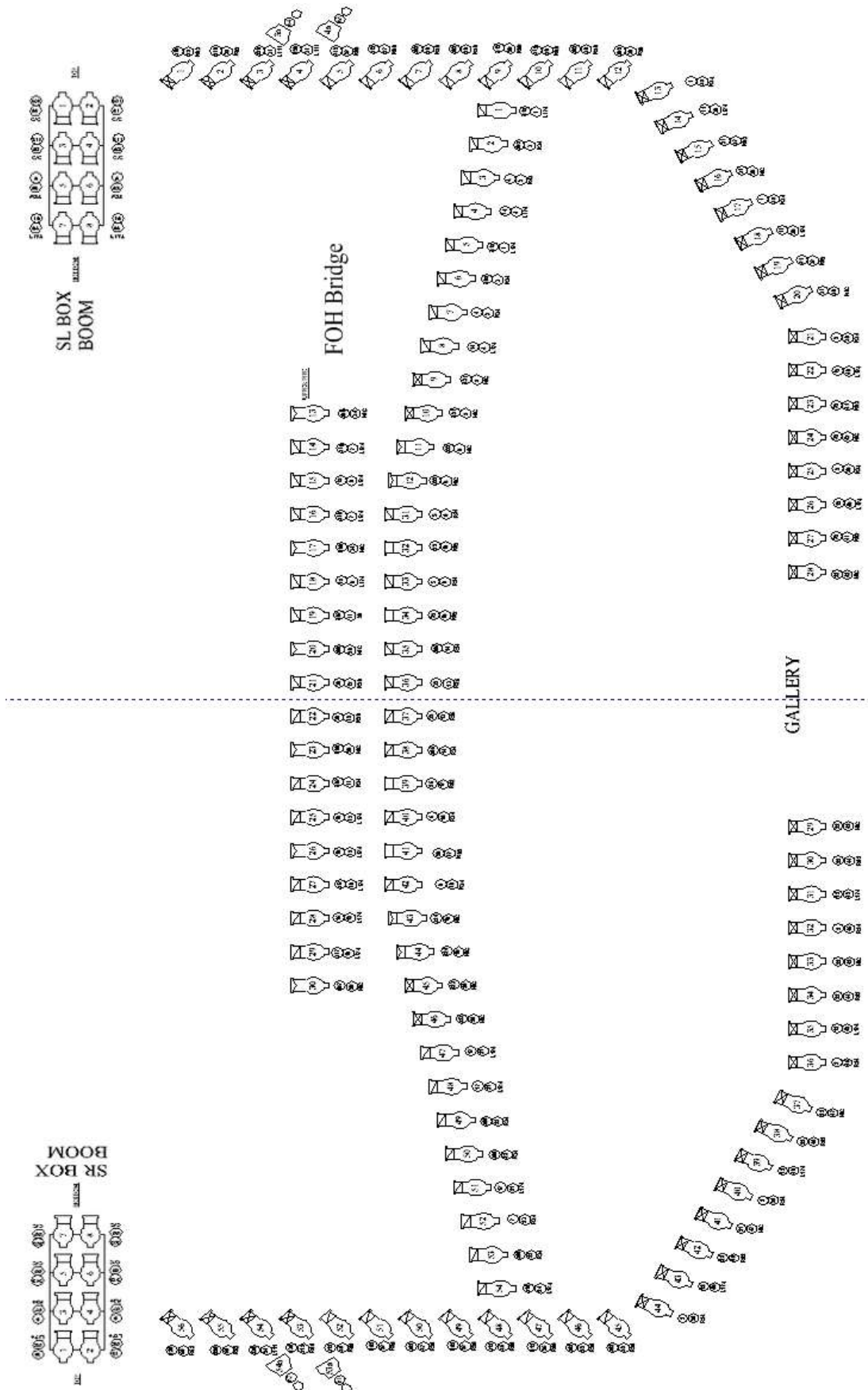

Lighting Plot: Stage

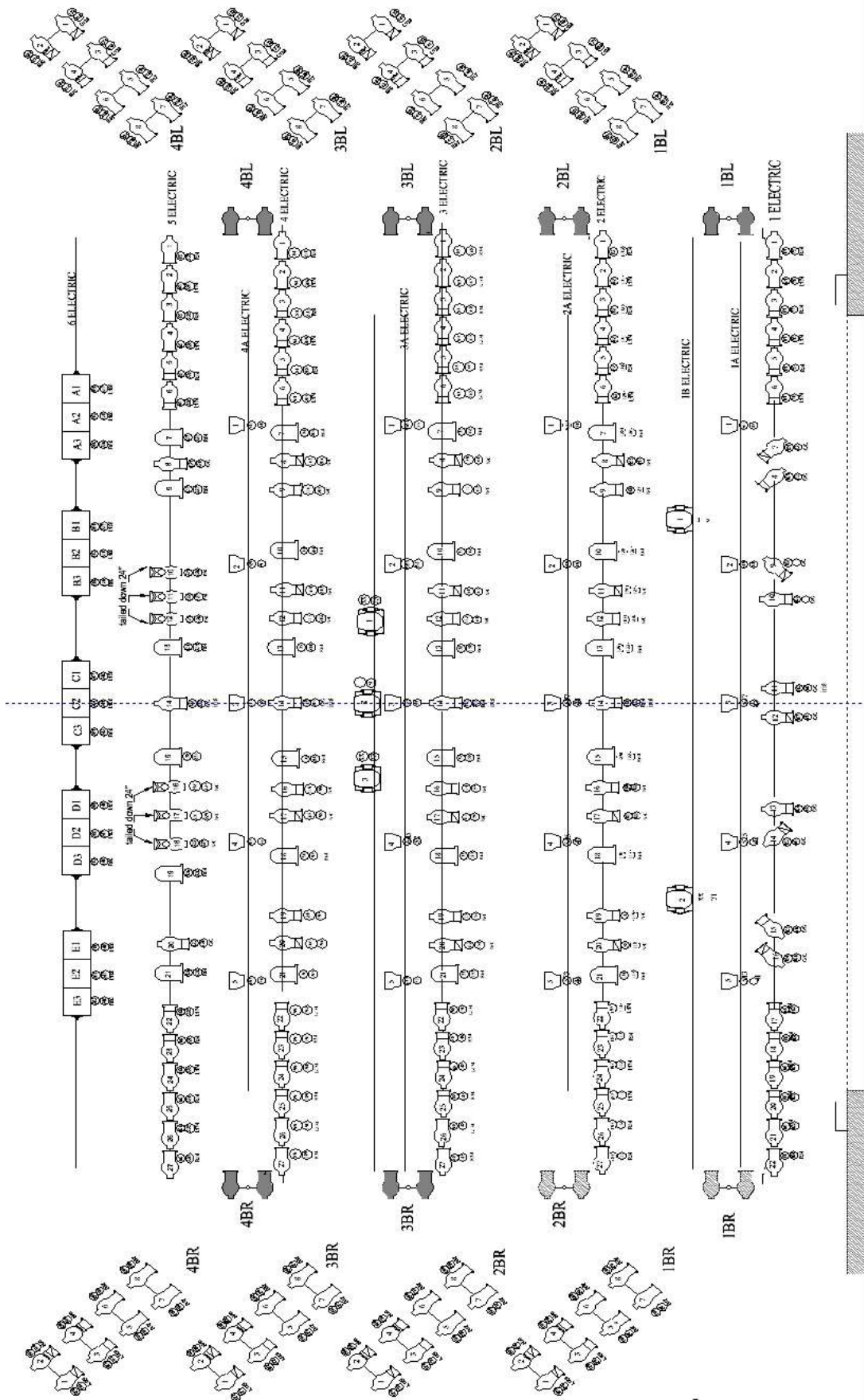

CIRCUIT LOCATION

| CIRCUIT | Location | Notes |
|-----------------|----------------------------------|--------------------------|
| 1-24 | FOH Cove | |
| 25-38 | Technical Gallery SL | |
| 39-46 | Technical Gallery REAR | |
| 47-60 | Technical Gallery SR | |
| 61-64 | Box Boom SL | |
| 65-68 | Box Boom SR | |
| 69-74 | Orchestra Pit | |
| 75-104 | #1 Electric Raceway | (attached to Line Set 4) |
| 105-110 | Drop Box SL | 4'4" from Plaster Line |
| 111-116 | Drop Box SR | 4'6" from Plaster Line |
| 117-128 | Drop Box SR | 8' from Plaster Line |
| 129-134 | Drop Box SR | 9'10" from Plaster Line |
| 135-140 | Drop Box SR | 10'10" from Plaster Line |
| 141-146 | Drop Box SL | 13'1" from Plaster Line |
| 147-152 | Drop Box SR | 13'4" from Plaster Line |
| 153-164 | Drop Box SR | 16'4" from Plaster Line |
| 165-170 | Drop Box SR | 18'10" from Plaster Line |
| 171-176 | Drop Box SR | 19'10" from Plaster Line |
| 177-182 | Drop Box SL | 22'2" from Plaster Line |
| 183-188 | Drop Box SR | 22'6" from Plaster Line |
| 189-200 | Drop Box SR | 25'6" from Plaster Line |
| 201-206 | Drop Box SR | 28' from Plaster Line |
| 207-212 | Drop Box SR | 29' from Plaster Line |
| 213-224 | Drop Box SL | 30' from Plaster Line |
| 225-236 | Drop Box SR | 30' from Plaster Line |
| 237-242 | Drop Box SL | 31'6" from Plaster Line |
| 243-248 | Drop Box SR | 31'6" from Plaster Line |
| 249-254 | Fly Gallery SL | |
| 255-260 | Fly Gallery SR | |
| 261-264 | DSL Wall | |
| 265-268 | DSR Wall | |
| 269-272 | USL Wall | |
| 273-288 | USR Wall | |
| NON-DIMS | | |
| A,B | FOH Cove and Technical Galleries | |
| C,D | Fly Galleries SL and SR | |
| E,F,G,H | DSL, USL, DSR, USR | |

ORCHESTRA EQUIPMENT AND CONCERT SHELL

ORCHESTRA EQUIPMENT

| | |
|----|------------------------------|
| 96 | Wenger Orchestra Chairs |
| 6 | Cello Chairs |
| 87 | Music Stands w/lights |
| 1 | Conductor's Podium and Stand |
| 10 | Stools |
| 10 | 3'x 6' Tables |

RISERS: Black skirting is available for risers

| | |
|----|---------------|
| 10 | 4'x 8'x 8''h |
| 10 | 4'x 8'x 16''h |
| 20 | 4'x 8'x 24''h |

STEP UNITS:

| | |
|---|-----------------------|
| 2 | 8'' single step units |
| 2 | 16'' step units |
| 2 | 24'' step units |

PIANOS (Note: Pianos tuned only by House Tuner Only - tuning not included)

| | |
|---|-----------------------------------|
| 2 | 9' Steinway Concert Grand Model D |
| 1 | 7' Steinway Grand Model B |
| 3 | Yamaha Uprights |

ORCHESTRA CONCERT SHELL:

The Amaturio Theatre is equipped with 13 Wenger acoustical shell walls that can be arranged in a variety of configurations. Each shell piece is 6' wide in approximately 12' high with a 2' outrigger on the rear. Each shell piece is easily moveable with locking casters.



DRESSING ROOM / WARDROBE / SUPPORT SPACES

DRESSING ROOMS:

All dressing rooms are located directly behind the stage, and are accessible from either side. The numbering starts closest to SL, and proceeds across to SR. All rooms are equipped with showers, toilets, mirrors, chairs and costume racks. The smaller dressing rooms have a counter running the length of one long wall, while the larger rooms have counters running along both long walls. Companies working under an AEA contract should use the smaller number for dressing room assignments. There is an audio feed from the stage throughout the area.

| Dressing Room # | Number of People | Dimensions |
|-----------------|------------------|------------------|
| Room #115 | 6-8 people | 8' 6"W x 18' 4"L |
| Room #116 | 12-18 people | 14' W x 18' 4"L |
| Room #117 | 12-18 people | 14' W x 18' 4"L |
| Room #118 | 6-8 people | 8' 6"W x 18' 4"L |



WARDROBE ROOM:



There is no dedicated Wardrobe room at the Broward Center, just a small room for minor repairs. Shows booked into the Au-Rene Theatre have priority use of this room.

LAUNDRY ROOM:

The center has one laundry room to facilitate both theaters. located on stage level between the two theater spaces. There are three washers and three dryers in the laundry room, as well as a double sink.

Arrangements must be made in advance, as shows booked the Au-Rene Theatre have priority use of this room.



It is
into

CARPENTRY SHOP

Broward Center has a small wood shop for general repairs and limited welding equipment for metal & steel, located in the Au-Rene backstage. Its availability is dependent on activity in the Au-Rene Theatre.



GREEN ROOM / WARM-UP SPACE

The Amaturio Green Room is 35' x 11' 6", and has a commercial grade coffee maker, standard refrigerator/freezer, and a sink. There is an audio feed from the stage, and a CCTV connection (television not included). It can be used as a Catering Room, a Wardrobe Room, a Production Office or a Rehearsal/Warm-up room. It has a section of mirrors and barres.

-INSERT UPDATED GREEN ROOM PHOTO HERE-

There are additional mirrors and barres outside of dressing room #118. and in the stage entrance to Stage Left.



Up

SUPPORT SPACES

The Amaturio Theater is not equipped with office space for clients, but each dressing room, as well as the Green Room, can be equipped with a phone line and a high-speed internet connection. Room #118 has been the traditional favorite for production use, but any of the rooms can set up as an office. Phone and internet connections require advance notice, as the available outside lines must be shared with the Au-Rene Theater.

ADDITIONAL RENTAL SPACES

The following space must be reserved in advance, and is subject to availability: The Einstein Room is 36' x 18' and is located next to Au-Rene Green Room. It has no mirrors or bars.

Backstage Map

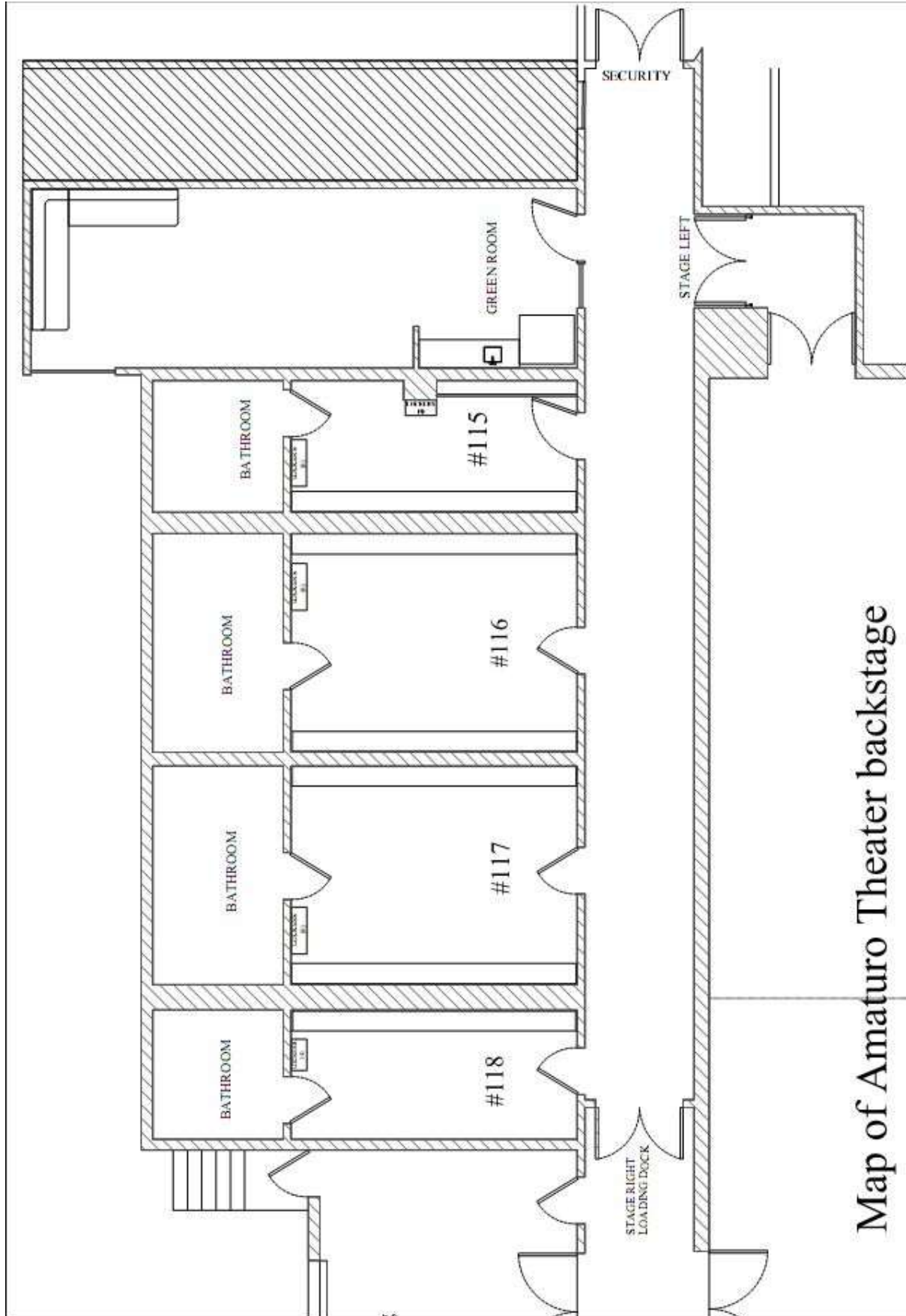

Map of Amaturu Theater backstage

LOCAL SERVICES

GROUND TRANSPORTATION

Checker Taxi
954-923-9999

Yellow Cab
954-777-7777

Broward County Transit
954-357-8400
www.Broward.org/bct

A Personal Touch Limousine Service
800-741-2785
<http://www.aplimo.net/>

Water Taxi
954-467-6677

Sun Trolley
954-761-3543

Tri-Rail
(800) 874-7254
www.Tri-rail.com

LODGING INFORMATION

The Broward Center for the Performing Arts maintains several official lodging partners. If your organization is seeking housing, please contact the following properties and identify yourself as an artist, crew or patron of the Broward Center. The hotel will give you our special rates if available.

Hampton Inn
250 N. Andrews Ave.
Fort Lauderdale, FL 33301
954.924.2700
hamptoninnftlauderdale.com

Sonesta Fort Lauderdale
999 North Fort Lauderdale Beach Blvd
Fort Lauderdale, FL 33304
954-315-1460
www.sonesta.com/fortlauderdale

W Fort Lauderdale
999 N. Fort Lauderdale Beach Blvd.
Fort Lauderdale, FL 33304
866.616.2572
wfortlauderdalehotel.com

Riverside Hotel
620 E. Las Olas Blvd.
Fort Lauderdale, FL 33301
800.325.3280
riversidehotel.com

BANKING

Sun Trust Bank
601 W. Broward Blvd
Fort Lauderdale, FL 33312
954-713-1492

Bank of America
401 East Las Olas Blvd
Fort Lauderdale, FL 33301
954-524-6581

Wells Fargo
1 East Broward Blvd
Fort Lauderdale, FL 33301
954-762-9200

COPIES/PRINTING

FedEx Office
300 North Federal Highway
Fort Lauderdale, FL 33301
954-467-1007

Reprograffia (Blueprints)
801 N. Andrews Ave
Fort Lauderdale FL 33301
954-525-0157

DELIVERY SERVICES

US Post Office
400 NW 7th Ave
Ft. Lauderdale, FL 33311
(800) ASK-USPS
954-523-0327

The Broward Center has regularly
scheduled daily delivery/pick up from UPS,
FedEx and USPS

ENTERTAINMENT / ATTRACTIONS

Ft. Lauderdale has many choices for entertainment all year around from beaches to museums and everything in-between. Here are just a few choices.

AutoNation IMAX Theatre
(at the Museum of Discovery & Science)
401 S.W. 2nd Street
Fort Lauderdale, FL 33312
954-467-6637

Greater Ft. Lauderdale Convention &
Visitors Bureau
954-765-4466
www.sunny.org

Museum of Art Fort Lauderdale
One East Las Olas Blvd.
Fort Lauderdale, FL 33301
954-525-5500

Billie Swamp Safari
(Everglades Tours, Airboat rides, Swamp
Buggy rides)
800-GO-SAFARI
www.billieswamp.com/

Seminole Hard Rock Hotel & Casino
1 Seminole Way
Hollywood, Florida 33314
954-327-7625

DINING / NIGHTLIFE

Please check out the “Go Riverwalk” and “Riverwalk A & E” websites below for more information on restaurants and nightlife surrounding the Broward Center.

<http://www.goriverwalk.com/>

<http://www.riverwalkartsandentertainment.com/>

The Production Department has menu books available which includes local restaurant menus, many with take-out and delivery available. There are many restaurants, bars and clubs within walking distance of the Broward Center. Here are just a few choices.

Himmarshee Public House
201 SW 2nd Street
Fort Lauderdale, FL 33301
954-616-5275

<http://publichouseftl.com/>

Walking Distance: .02 mile

YOLO

333 E Las Olas Blvd
Fort Lauderdale, FL
954-523-1000)

www.yolorestaurant.com

Walking Distance: 1.1 mile

The Chimney House
701 W Las Olas Blvd
Fort Lauderdale, FL 33312
954-900-5352

www.thechimneyhouse.net

Walking Distance: .01 mile (next to BCPA)

15th Street Fisheries
1900 SE 15th Street
Fort Lauderdale, FL 33316
954-763-2777

www.15streetfisheries.com

Walking Distance: 2.77 miles

Bimini Boatyard
1555 SE 17th Street
Fort Lauderdale, FL 33316
954-525-7400

www.biminiboatyard.com

Walking Distance: 3.01 miles

Tarpon Bend (restaurant & bar)
200 SW 2nd Street
Fort Lauderdale, FL 33301
954-523-3233

www.tarponbend.com

Walking Distance: .04 mile

Tilted Kilt
219 S. Andrews Avenue
Fort Lauderdale, FL 33301
954-763-5458

www.tiltedkilt.com

Distance: 0.4 miles

Grille 401
401 E Las Olas Blvd
Fort Lauderdale, FL 33301
954-767-0222

www.grille401.com

Walking Distance: Less than 1 mile

The Royal Pig Pub
350 East Las Olas Boulevard
Fort Lauderdale, FL 33301
954-617-7447

<http://www.royalpigpub.com/>

Walking Distance: 1.2 Miles

Café Vico
1125 N. Federal Highway
Fort Lauderdale, FL 33304
954-565-9681

www.cafevicorestaurant.com

Distance: 3.1 miles

FLORISTS

Ann's Florist & Greenhouse
1001 E Las Olas Blvd
Fort Lauderdale, FL
954-761-3334

A Basket Affair
830 E. Oakland Park Blvd, Suite 101
Oakland Park, FL 33334
954-567-2052

GYM

Bally Total Fitness
750 W Sunrise Blvd
Fort Lauderdale, FL 33312
954-764-8666

The Firm Fitness Center
928 N Federal Hwy
Fort Lauderdale, FL 33304
954-767-6277

The Fitness Company
110 SE 6th St – 7th Floor
Contact Rhonda 954-761-1110
FAX 954-463-4952

LA Fitness
3825 N. Federal Hwy.
Contact: Matt 954-567-2727
Day Passes \$15.00

HAIR

Las Olas Barber Shop
1400 E. Las Olas Blvd.
Ft. Lauderdale, FL 33301
Open 7 days a week, will come to theatre
954-462-1351

Source Spa & Salon
1881 NE 26th Street, Suite 30
Wilton Manors, Florida 33305
954-568-1998

HARDWARE/SUPPLIES

Home Depot
1000 NE 4th Street
Fort Lauderdale, FL 33304

McDonald's Hardware
245 SW 24 Street
Fort Lauderdale, FL 33315
954-463-2000

Miami Stagecraft (sales & rentals)
2855 East 11th Ave
Hialeah, FL 33013
305-836-9356
(9:00 am – 5:00 pm M-F)

Stage Equipment and Lighting, Inc.
12250 NE 13th Court
Miami, FL 33161
(305) 891-2010

LAUNDRY / DRY CLEANING

Dry Cleaning Depot
730 W. Broward Blvd
954-522-1126

Fashion Cleaners
2427 W. Broward Blvd
954-583-8225

SHOPPING

Publix (Grocery and Pharmacy)

601 South Andrews Avenue
Fort Lauderdale, FL 33301
954-728-8330
(7:00am – 11:00pm)

Whole Foods Market

2000 N Federal Hwy
Fort Lauderdale, Florida 33305
954-565-5655
Mon - Sun: 8am - 10pm

Walgreen's Pharmacy

700 Broward Blvd
Fort Lauderdale 33301
954-463-9937
(7:00am- 11:00pm)

Galleria Mall

2414 East Sunrise Blvd
Fort Lauderdale, Florida 33304
Phone: 954-564-1015

The Fresh Market

424 N Federal Hwy, Fort Lauderdale, FL
33301
954-763-1250
Mon - Sun: 8am - 10pm

CVS/Pharmacy

1 North Federal Highway
Fort Lauderdale, FL 33301
954-524-0500

7-11

460 W Broward Blvd,
Fort Lauderdale, FL
954-467-3856
(24 Hour)

Sawgrass Mills Mall (Outlet Mall)

12801 West Sunrise Blvd
Sunrise, FL 33323
954-846-2350

MASSAGE (will come to theater or housing)

James Perc
(Swedish and Deep Tissue massage; Hot Stone)
Lic # MA43130
954-534-6611
bodyworkbyjim@yahoo.com

Lawrence Zwarich
(Swedish and Deep Tissue massage)
Lic # MA43125
954-383-8891
cdnlar@hotmail.com

Diva's Day Spa
Full-service Spa located next door to the
Broward Center in the Symphony building.
Will come to the theater for massages.
954-522-1141 x 6 or 954-771-9772
(ask for Jacki and let her know you are a performer
at the Broward Center for a discount on services)

MEDICAL

Hospitals and clinics are listed first, followed by Doctors (listed alphabetically by specialty)

HOSPITALS

Broward General
1600 South Andrews Avenue
Fort Lauderdale FL 33304
954-355-4400

Imperial Point Medical Center
6401 North Federal Highway
Fort Lauderdale, FL 33308
954-776-8500

URGENT CARE

Broward Health Urgent Care
200 Northwest 7th Avenue
Fort Lauderdale, FL 33311
954-759-6794

Concentra Urgent Care Center
1347 S. Andrews Avenue
Fort Lauderdale, FL 33304
954-767-9999

Health Med Centers (Cash/Credit Only)
1493 SE 17th Street
Fort Lauderdale, FL 33316
954-525-7595

CHIROPRACTIC

Downtown Chiropractic Center
1601 E. Broward Blvd.
Ft. Lauderdale, FL
954-463-1166

Marcus Chiropractic Center
Dr. Peter Marcus
2710 E. Oakland Park Blvd, FT L 33306
954-566-3027 (Will make House Calls)

Dr. Patrick Helmer - Chiropractor
9532 Griffin Rd. Suite 1800
Cooper City, FL 33328
954-434-1800

DENTAL

Dr. Ari Arocha
113 SW 11th Ct
Ft Lauderdale, FL 33315
(954) 463-7972

Dr. Thomas Jeson
3000 E. Commercial Blvd.
Ft. Lauderdale, FL 33308
954-491-1904
fax – 954-772-3453

Dr. Larry Levinson
9 SW 17th St.
Ft. Lauderdale, FL 33315
954-524-3117
Beeper 209-8945

Dr. Jeffrey Bartlett
2440 E. Sunrise
In the Galleria Mall
954-566-8668

DERMATOLOGY

Dr. Babinski
1102 E. Broward Blvd.
Fort Lauderdale, FL 33312
954-463-5406

Dr. Smith / Las Olas Dermatology
800 E. Broward Blvd. Suite 507
Ft. Lauderdale, FL 33301
954-763-4331

EAR / NOSE/ THROAT

Dr. Herbert Moselle, ENT
201 NW 82nd Ave.
Plantation, FL 33324
954-472-1212

Dr. Bruce Weissman* - ENT, Voice Care
2100 Hallandale Beach Blvd Suite 405
Hallandale, FL 33009
o: 954-454-0544 cell: (305) 505-0666;
beeper: (305) 727-6939
*will make theatre calls

EYE CARE

Dr. Goldberg and Dr. Nolan
Eye Physician & Surgeon
2334 NE 53rd Street
Ft. Lauderdale, FL 33308
(954)776-2020

FAMILY/GENERAL PRACTICE

Dr. Ed Grenet - Health-Med Centers
1493 SE 17th Street
Ft. Lauderdale, FL 33316
954-525-7595 fax# 954-525-7599

Dr. Harvey Kleiner, DO
8890 W Oakland Park Blvd, Suite 100
Fort Lauderdale, FL 33351
954-741-3304

Dr. Myron Davidson
2500 NE 15th Ave
Wilton Manors, FL
954-533-5382

Dr. Glenn Moran, DO
Plantation Family Medical Assocs
201 Northwest 82nd Avenue Suite 401
Plantation, FL 33324
954-472-5100

OB/GYN

Dr. Gail Pezzullo-Burgs
(561) 392-7704 (Specify Plantation office)

All Women's Health
954-452- 5850

Dr. Trudi Fahey at Broward Medical Center
954-467-2013

Dr. Amy Sonnenblick
954-635-6243

ORTHOPEDICS

Dr. Bruce Fletcher
Northwest Broward Orthopedic Associates
5901 Colonial Dr, Suite 201
Pompano Beach, FL 33063
954-979-3255